

KRAIBURG puzzled mat CALMA

prerequisites:



concrete area:

- no holes
- no elevations
- with at least a 3 % slope

mats:

even temperature: minimum 5° C to maximum 30° C (store according to initial temperature)

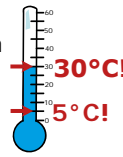

for animal well-being some litter is necessary to absorb moisture (e.g. soft milled straw or mineral material)

You will need this:

measuring:

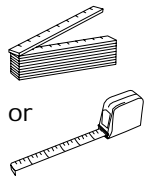

marking:

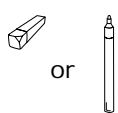

cutting:

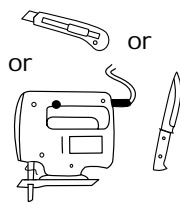

drilling and installing:

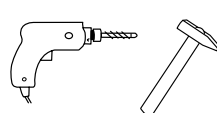

KRAIBURG fastening elements:



- nail plugs \varnothing 10 x 80 mm - A2
- washers \varnothing 30 mm - A2

(or fastening elements with at least the same resistance and durability)

1 Lay out mat row completely



tip: first mark a 3 cm distance from the rear concrete edge along the whole length (a chalk line works well for this)

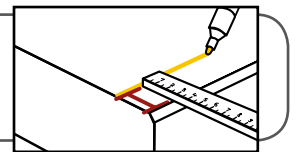

prepare to fasten at the front

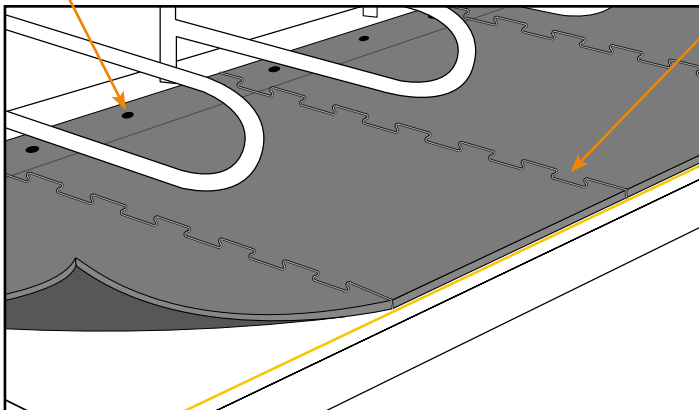

puzzle seam independent of dividers

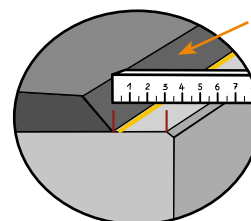

chamfer

rear concrete edge:
minimum 3 cm distance!

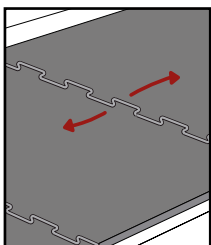

join mats loosely, lift them slightly and gently pull them apart

! avoid creating tension!

DO NOT PRESS!

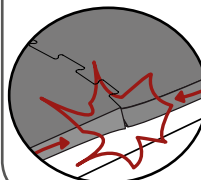

DO NOT PULL ON ONE SIDE ONLY!

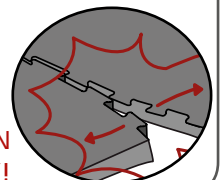

Mushroom divider:

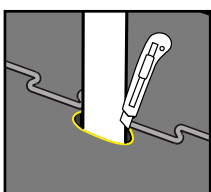

cut mats to fit



② Fastening

fasten at the front through the prefabricated holes

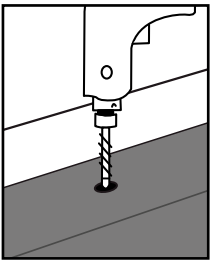
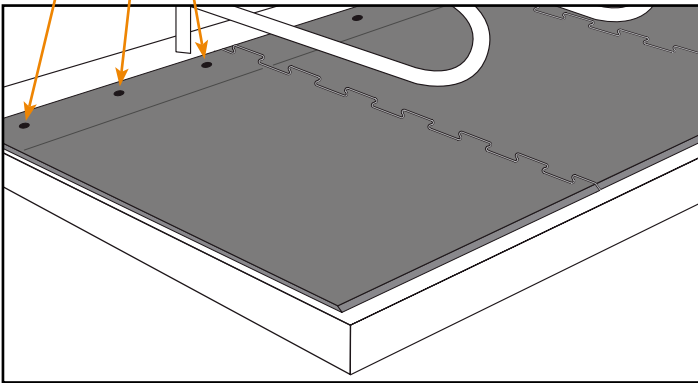

drill

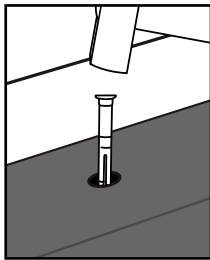

pound the
plastic plugs
in flush

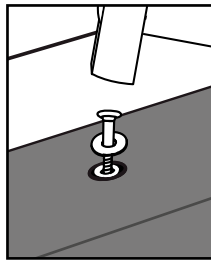

pound in nails and washers until
they are seated evenly fast and
are slightly countersunk

When using in a cubicle for fattening bulls:

additionally fasten 2 x at the mat's rear edge:

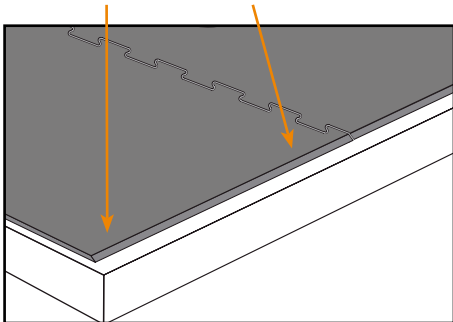

distance from
side edge:
about 8 cm

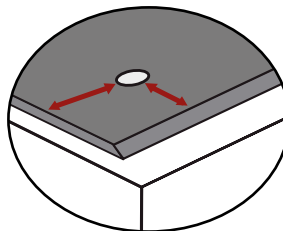

distance from rear
edge: about 5 cm