

## KRAIBURG WINGFLEX

### prerequisites:



#### concrete area:

- no holes
- no elevations
- with at least a 3 % slope

#### mats:

even temperature: minimum 5° C to maximum 30° C (store according to initial temperature)

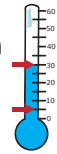

for animal well-being some litter is necessary to absorb moisture (e.g. soft milled straw or mineral material)

### You will need this:

#### measuring:

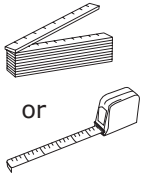

#### marking:

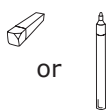

#### cutting:

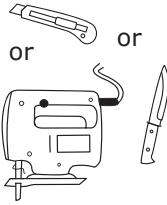

#### drilling and installing:

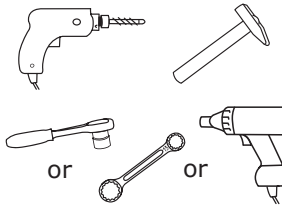

#### KRAIBURG fastening elements:

- framing plugs  $\varnothing$  10 x 100 mm with
- hexagon screw (SW 13) - A2
- washer  $\varnothing$  30 mm - A2

(fastening elements are part of delivery)

#### mat width:

102 cm

102 cm

112 cm

112 cm

112 cm

#### profile width:

8 cm

13 cm

8 cm

13 cm

18 cm

#### cubicle width:

110 cm

115 cm

120 cm

125 cm

130 cm



do not stack the pallets!

## 1 Lay out mat row completely and set distances by means of the assembling tool

**i** Start from the middle of the cubicle row and install to the right and to the left

fastening holes on the front edge

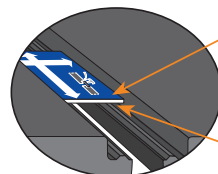
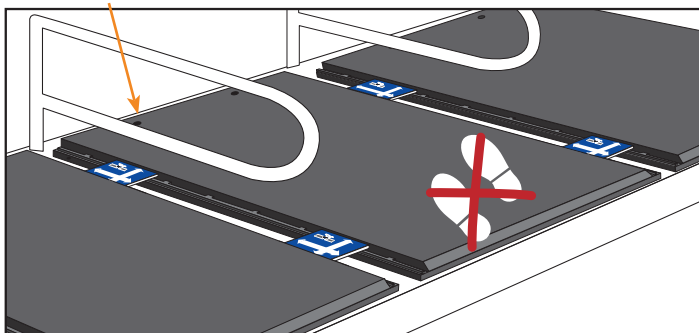

to install loosely set distance between mats by means of the assembling tool (wider than profile)

indent assembling tool approx. 20 cm

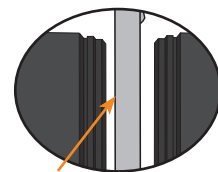

position under the divider (+/- 6 cm)

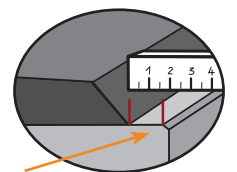

rear concrete edge: 0 - 3 cm distance

**!** When pulling the mat, take care that the wings do not turn into the opposite direction! Do not walk on it until screwed on tightly!

## 2 Insert profiles

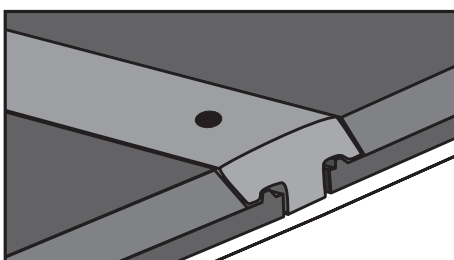

- chamfered side to rear
- profile engages flush with the interlocking rear mat edge



### 3 Fix profile 5x, but not yet tighten fast

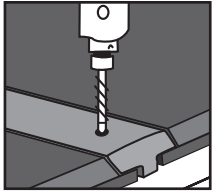

drill

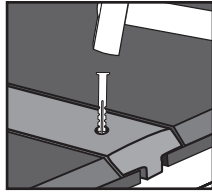

pound the plastic plugs in flush

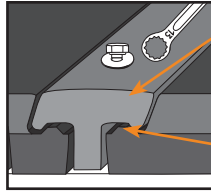

turn in screws and washers loosely, not yet fasten tightly

profile engages in the flute of the mat edge

flute



**tip:**  
avoid profile slippage:  
1. drill first hole  
2. pound in a plug (-> fixation)  
3. afterwards drill further holes and so on

**When the whole lying mat row is already laid out and fixed loosely:**

### 4 Fasten profiles and mats

**A** fasten profiles 5x

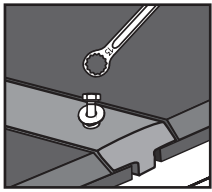

finally fasten all pre-assembled screws

**B** fasten mats at front edge 2x

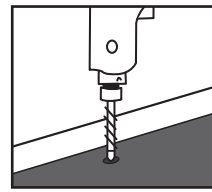

drill

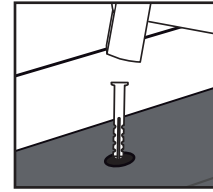

pound the plastic plugs in flush

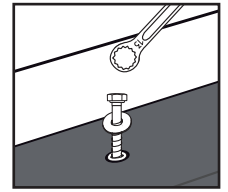

fasten screws and washers



fasten screws until they are seated evenly fast, **do not overtighten!**

### 5 Fasten last side mat edge

with "end"-profile:

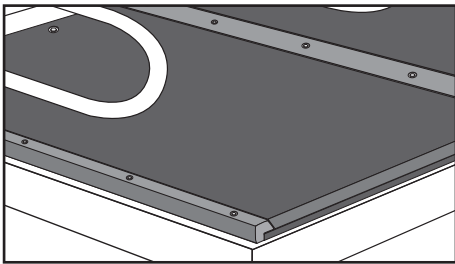

fasten with "end"-profile

or

with no profile:

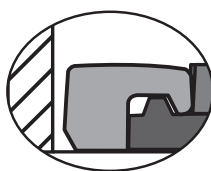

minimum 0.5 cm distance to the wall

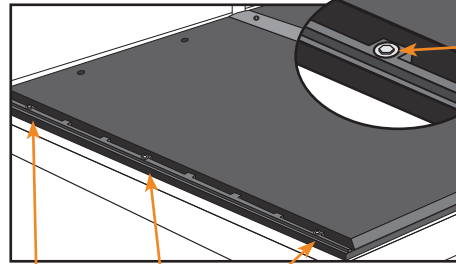

fasten edge with 3 fastening elements

ideal position

if cut to shape:

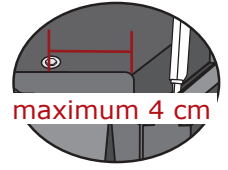

maximum 4 cm

set fastening max. 4 cm away from the upper mat edge

### Mushroom dividers

mat:

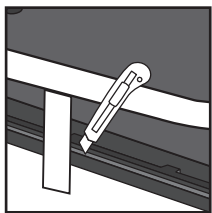

thinner side edge can be cut in up to 3 cm



maximum 3 cm

profile:

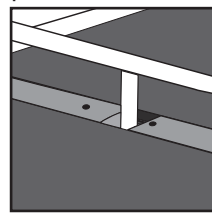

if required, divide the profile, adapt it and **fasten additionally**



**for adapting the profiles a handsaw or a handheld circular saw is suitable**



**important:** profile covers the joint over the whole mat length (also with mushroom dividers)